



DATA SHEET

fuse-switch-disconnector

Tytan II Do-63-3/E

With flashing indicator in fuse plug, without fuse

Article number 09980100



Function

Fuse-switch-disconnectors combine the fuse protection of system parts with switching capability under load as well as when in overload. Tytan II series devices are main fuse switch-disconnectors for Do1 and Do2 fuses. Simultaneous isolation of all phases is ensured by the screwcap-less plug-in technology. In contrast to the earlier screwcap technology, in which perfect contact could not be guaranteed, the mechanics of the series prevent the formation of high transitional resistances and therefore minimise thermal dissipation power. Disconnectors of this design are equipped with fuse plugs and colour-coded fitted cartridges according to the rated current. The plug sets have a flashing indicator that indicates failure of a fuse.

Features

low current heat losses, suitable for fuses Do1 and Do2, finger and back-of-hand proof, large clamping area

Mounting

quick fastening to mounting rail, any installation position

Applications

The components are suitable for use in power supplies to residential and purpose-built buildings as well as industrial facilities.

Notes

All variants are supplied without fuses. These can be obtained separately.

Accessories

fuse plug sets DSE, restart locks Tytan WES, wiring components Do busbar can be cut to length, input terminals DK

Technical Data

Technical Data	Tytan II Do-63-3/E
Series	Tytan
Number of poles	3
Handling	plug-type technology without screw caps, similar to NH technology
Suitable for fuses	Do1: 1 A*, 2 A, 4 A, 6 A, 10 A, 13 A, 16 A (* – not standardised) Do2: 20 A, 25 A, 32 A, 35 A, 40 A, 50 A, 63 A
	load circuit
Specification	switching contact
Rated voltage (AC)	400 V
Rated voltage (DC)	max. 220 V
Rated current (AC)	63 A
Rated short-circuit current	50 kA
max. total rated switching capacity	50 kA
Rated insulation voltage	690 V
Rated impulse withstand voltage	6 kV
Allowed utilization category	AC-22b, DC-21b
Overtoltage class	IV

Subject to technical changes

Technical Data	Tytan II Do-63-3/E
	screw-type terminal top, bottom (load circuit)
Protection against direct contact	finger and back-of-hand proof
Cross section solid	1-wire: 1.5 mm ² ... 35 mm ²
Connecting capacity flexible	1-wire: 1.5 mm ² ... 35 mm ² ; 2-wire: 1.5 mm ² ... 16 mm ²
Cross section flexible with ferrule	6 mm ² ... 35 mm ²
Cross section stranded	1-wire: 1.5 mm ² ... 35 mm ²
Tightening torque	max. 3 Nm
	Do2 (fuse mounting)
	General data
Operating position	optional
Mechanical endurance	min. 10000 switching cycles
Electrical endurance	min. 1500 switching cycles
Storage temperature	-25 °C ... 60 °C
Ambient temperature	-25 °C ... 40 °C
Housing type	distribution board housing
Installation type	Mounting rail (35 mm)
Housing material	thermoplastic
Protection class	IP20 (installed: IP40)
sealable	true
Width	81 mm
Height	86 mm
Depth	70 mm
Module widths	4.5
Design requirements/Standards	EN 60947-3
Fire class/creep resistance	Vo, glow wire test 960° / CTI 600
Degree of pollution according to EN 60664	3

Dimensions

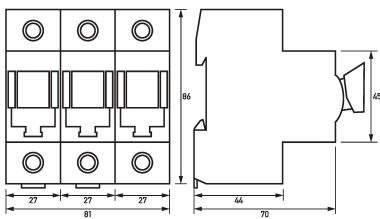

Dimensional drawing Group view

Wiring example

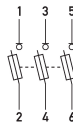

Wiring diagram